

MILA NORDIC 

Product Datasheet

25.6V, 120Ah



2026

Revision
January 2026

www.milanordic.dk 

Technical Specifications



Electrical Specifications

Battery Chemistry:	Lithium Iron Phosphate (LiFePO ₄)
Nominal Voltage:	25.6 V
Nominal Voltage Range:	21.2 to 28.5 V
Nominal Capacity:	120 Ah
Cycle Life (25°C, 0.5C/0.5C Charge/Discharge):	4,000 <i>(Approx. 80% capacity retention after 4,000 cycles)</i>
Cycle Count Method:	Coulomb Counting relative to nominal capacity
Maximum Charging Voltage:	27.6 V
Maximum Charging Current:	25 A
Pulse Discharge Current:	120 A (60 seconds)
Pulse Discharge Current:	200 A (10 seconds)
Peak Discharge Current:	300 A (1 second)
Cell Balancing Current:	150 mA
Active Mode Self-Discharge Rate:	≈20 mA
Sleep Mode Self-Discharge Rate:	≈1 mA

... continued



Mechanical Specifications

Dimensions L x W x H:	378 x 375 x 163 mm
Weight:	TBD
Enclosure Material:	Powder-coated steel
Protection Rating:	IP44
Installation Orientation:	Any direction excl. front
Terminal Type:	Anderson 120A (grey)
CAN Connector:	DB sub 9-pole

Environmental Specifications

Operating Temperature Range:	Charging: 0 °C to 55 °C Discharging: -5 °C to 45 °C
Short-term (<1 month) Storage Temperature Range:	0 °C to 35 °C
Long-term (>1 month) Storage Temperature Range:	15 ± 5 °C
Recommended SOC for Long-Term Storage:	80%
Relative Humidity Range:	5% to 90% (operation), 5% to 75% (storage)

... continued



Communication & Control

Integrated BMS Interfaces:	CAN 2.0A/B, Bluetooth
CAN Baud Rate:	125 kbit/s
Logged Parameters:	Time, voltage, current, temperature, SOC, SOH, charge/discharge cycles, errors
SOC Method:	Coulomb Counting & Kalman Filter
Protection Features:	Overvoltage, undervoltage, overcurrent, short circuit and temperature protection
Protection Reset Function:	Push-button
Temperature Monitoring:	2 sensors on cells 2 sensors on BMS

Safety & Certifications

Battery Pack Certifications:	CE, RoHS, REACH
Cell Certifications:	UN38.3, UL1642, UL1973, IEC62619, IEC62133
BMS Certifications:	EN IEC 61000-6-3:2021; IEC 62321-3-1:2013; ANSI C63.4:2014

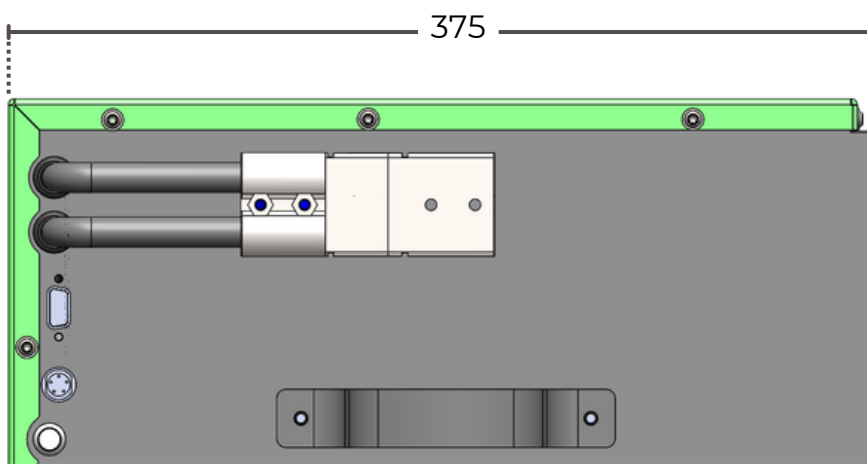
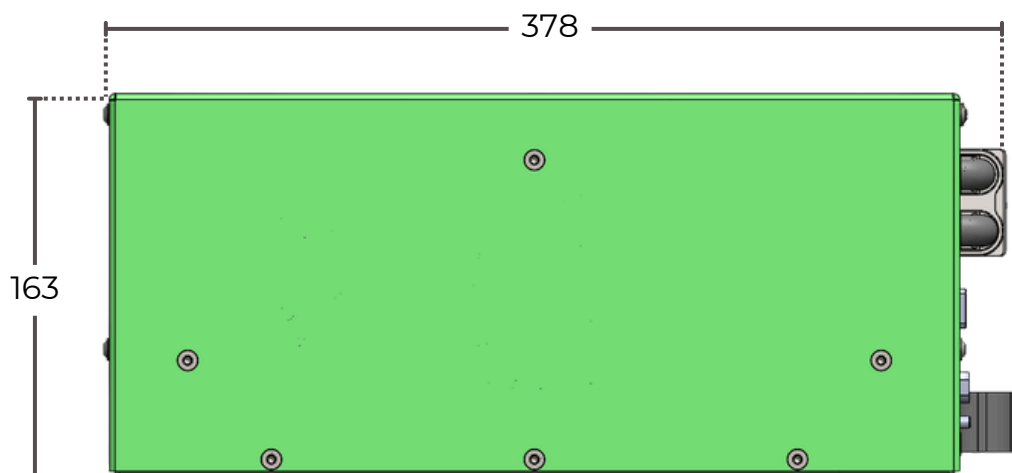
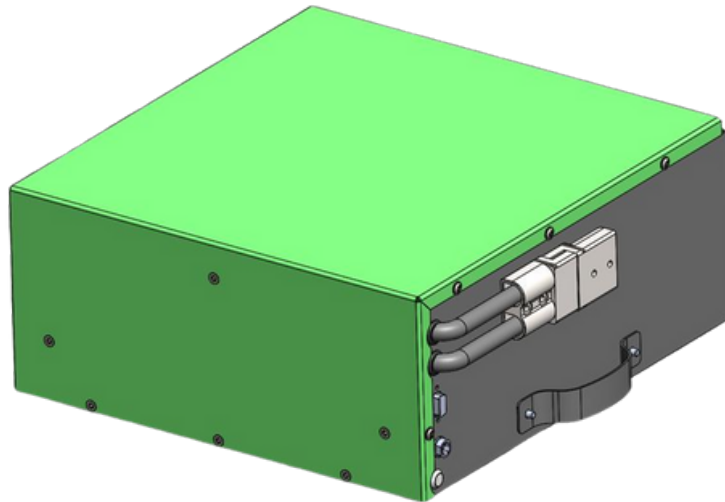

All dimensions are in mm and rounded to the nearest whole number.

CONTACT INFORMATION

MILA Nordic can be reached via



Info@milanordic.dk



+45 42 91 09 44



Frederiksborgvej 399, 4000 Roskilde, Danmark



www.milanordic.dk

